





Ian Anthony
The Estate Agents

Carr Moss Lane, Halsall, Ormskirk, L39 8RU

Guide Price £340,000

 3  1  2



- DESIRABLE RESIDENTIAL LOCATION
- WOODEN GARAGE & GARDENS FRONT AND REAR
- 3 BEDROOMS
- LIVING ROOM , DINING ROOM
- OPEN ASPECTS FRONT & REAR
- FAMILY BATHROOM
- KITCHEN
- SEMI DETACHED PROPERTY



A well presented semi detached family home offers spacious accommodation in the desirable location of Halsall. This lovely property enjoys a rural location with well maintained gardens and beautiful open views to both front and rear. The ground floor accommodation comprises a living room, dining room and kitchen. To the first floor there is a master bedroom along with two further bedrooms and a family bathroom. Outside there is a detached garage, with ample off road parking to front and attractive mature gardens. Viewing is highly recommended to appreciate this delightful property and what it has to offer as a whole.

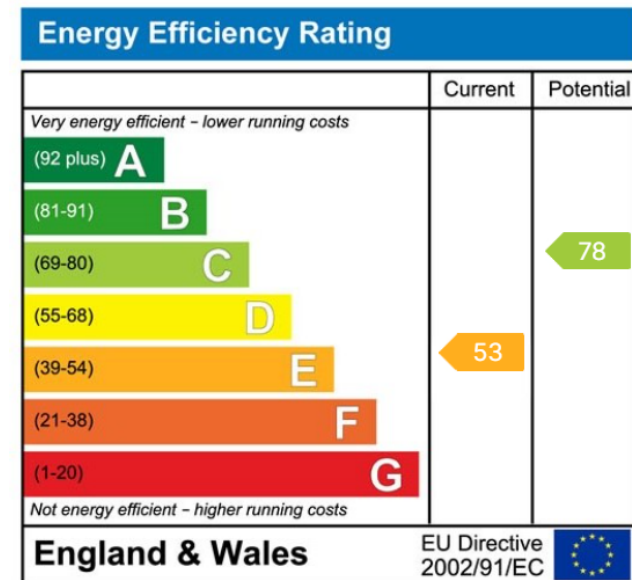
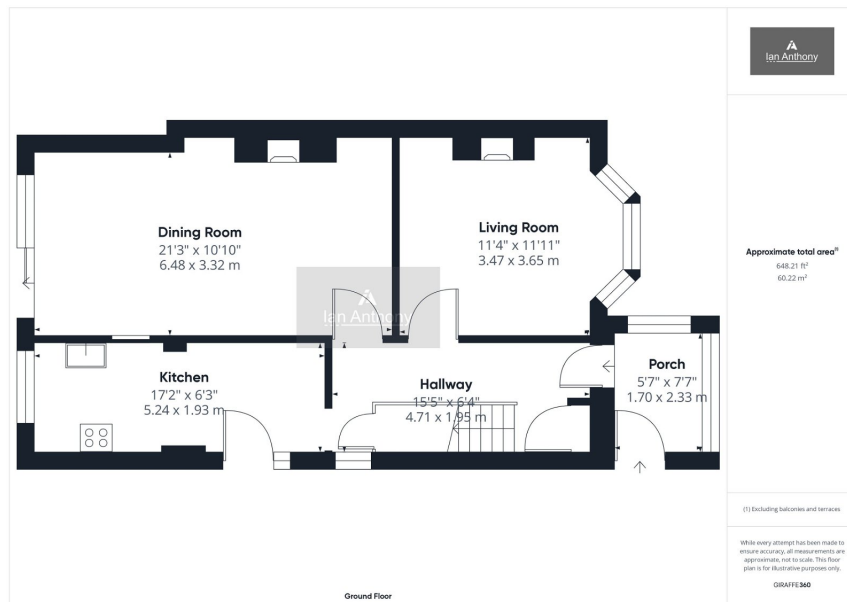

These particulars, whilst believed to be accurate are set out as a general outline only for guidance and do not constitute any part of an offer or contract. Intending purchasers should not rely on them as statements of representation of fact, but must satisfy themselves by inspection or otherwise as to their accuracy. No person in this firm's employment has the authority to make or give any representation or warranty in respect of the property.

5 Burscough Street, Ormskirk, Lancashire, L39 2EG

Tel: 01695 580888 Email: enquiries@iananthonyestates.co.uk <https://www.iananthonyestates.co.uk>